







Adam Hayes - North Finchley Office - Lettings 365 Ballards Lane, North Finchley, London, N12 8LL

Tel: 020 8445 4008 Email: info@adam-hayes.co.uk Web: www.adam-hayes.co.uk

Laburnum Close, London, N11 3NR

£1,725 PCM

 2 Bedrooms  1 Bathrooms  1 Receptions

Key Features

- Two Bedroom Purpose Built Apartment
- Modern Kitchen
- Modern Bathroom
- Wooden Flooring
- Gas Central Heating
- Off Street Parking

Other Information

Council Tax Band: C

Length of Tenancy: Long Let

Deposit: £1,990

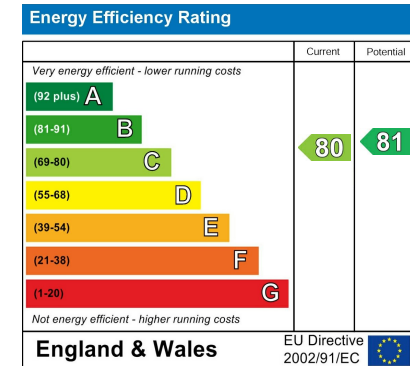

Nearest Stations

- New Southgate Rail
- Arnos Grove Tube

Property Description

A stylish two-bedroom purpose-built apartment located in this popular residential development within easy reach of New Southgate Rail Station, the A406, Tesco Express, and various local amenities. The property features a spacious lounge measuring approximately 16ft, seamlessly connected to a modern open-plan fitted kitchen. Additional highlights include a contemporary family bathroom, elegant laminated wooden flooring, gas central heating, double glazing, and an allocated parking space for one car. An internal viewing is highly recommended!

Adam Hayes - North Finchley Office - Lettings 365 Ballards Lane, North Finchley, London, N12 8LL

Tel: 020 8445 4008 Email: info@adam-hayes.co.uk Web: www.adam-hayes.co.uk

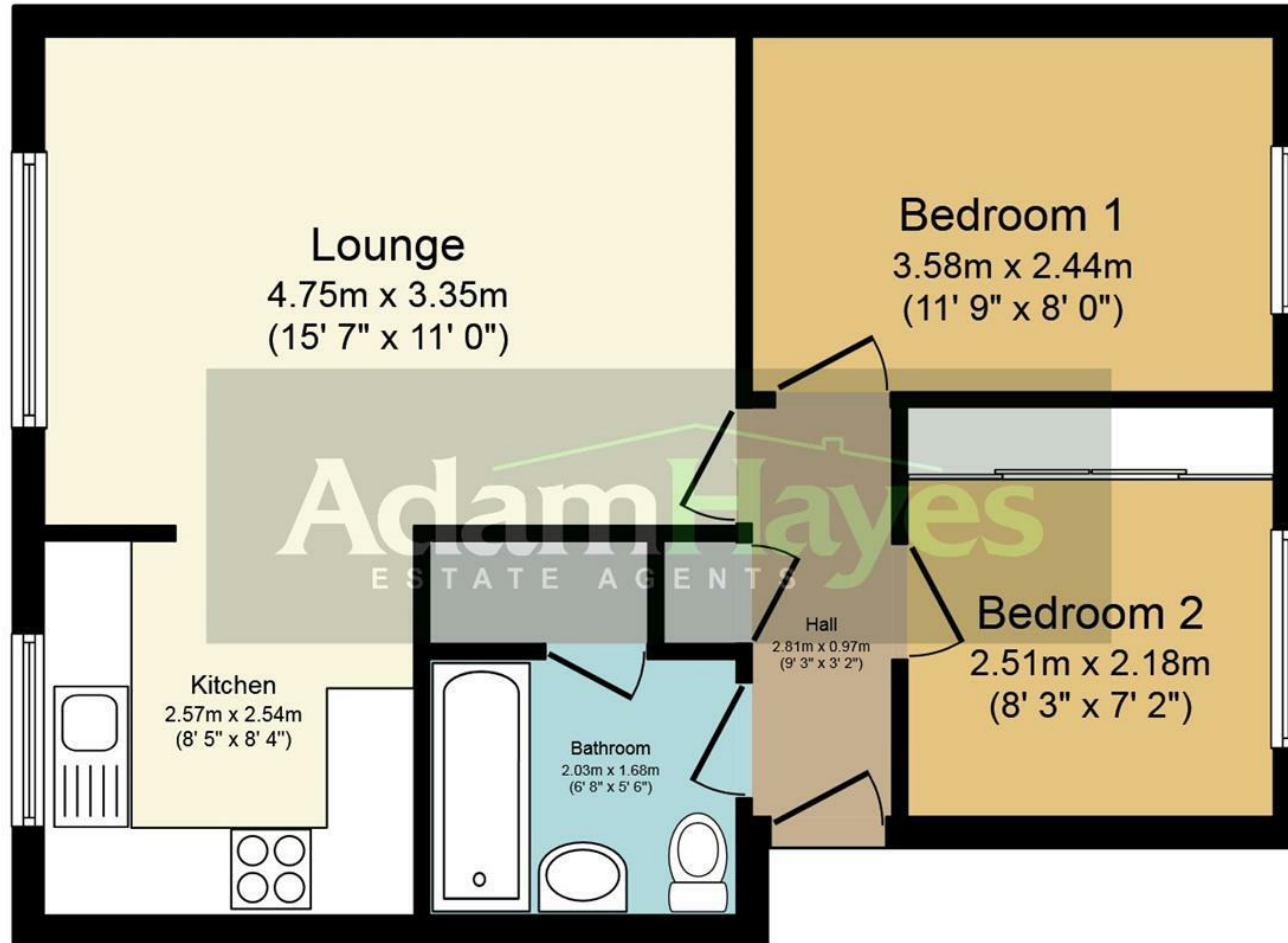

Floor Plan

Total floor area 48.3 sq.m. (520 sq.ft.) approx

This plan is for illustration purposes only and may not be representative of the property. Plan not to scale.

These particulars, whilst believed to be accurate, are set out as a general outline only for guidance and do not constitute any part of an offer or contract. Intending purchasers or prospective tenants should not rely on them as statements or representation of fact, but must satisfy themselves by inspection or otherwise as to their accuracy. We have not carried out a detailed survey, not tested the services, appliances and specific fittings. Room sizes should not be relied upon for carpets and furnishings. The measurements given are approximate. No person in this firm's employment has the authority to make or give any representation or warranty in respect of the property.